



Highland

kalon



Highland Bench - White Oak



Highland Chair – White Oak



Highland Chair



Highland Desk - White Oak



Highland Chair - White Oak



Kalon

Stemming from a belief in the beauty and emotive power of everyday objects, Kalon seeks to deepen our relationship and reverence for the things we live with. Kalon's work maintains a strong point of view informed by American furniture traditions and modernist design, with a focus on elemental forms, natural materials, and versatility. The studio prides itself on its intense attention to materiality, which is at the core of each design. With a commitment to ecologically-conscious, regional production, Kalon partners with small teams of highly skilled, fairly paid craftspeople and uses the highest quality, locally sourced natural materials and finishes. By balancing traditional craft modalities with high-tech precision manufacturing and modern forms, Kalon invites a new chapter of contemporary, sustainable design. Kalon was founded in 2007 and is based out of Los Angeles, California.

The Highland Collection

Named for the California uplands, Highland calls upon the rugged expanse of California's oak-laden, golden-hued hillsides. Made in a generous scale and cut from solid oak, Highland's proportions seek a balance between substance and elegance. In a nod to brutalism, the collection plays with slab-like, cantilevered forms and imperfect curves. Knobby flourishes call to mind the irregular character of the coast live oak trees endemic to California. These blunt shapes counterbalance the refined and clear precision of machining.

The collection, which includes a desk, extension dining table, chair and bench is built by a small team of master craftsmen in the North-Eastern United States using a mix of traditional and highly technological methods and a 360 degree approach to sustainability. Pieces are finished with Kalon's signature Bare Finish — a premium organic, natural oil-wax finish.

Highland was shot on location in Los Angeles at the Lovell Health House by Richard Neutra.



The Highland Extension Dining Table \$6,500 - \$7,800

DIMENSIONS

79 L x 39 W x 29.5 H

Full Extension 118" L

ORIGIN

Made in Pennsylvania

MATERIALS

American White Oak

FOOT OPTIONS



White Oak

CONFIGURATION OPTIONS

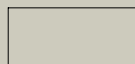

Extendable



Fixed

Made in a generous scale and cut from solid white oak, the Highland Extension Dining Table utilizes a sophisticated butterfly system that nests leaves discretely below the piece. When collapsed, the table seats 6. Fully extended the table is 118" long, comfortably accommodating 4 additional place settings.

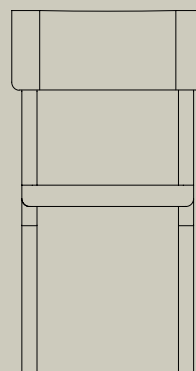
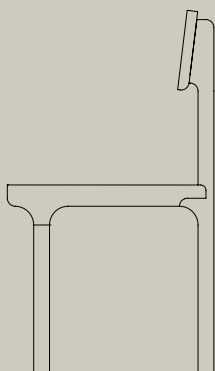

The Highland Chair \$1,500

DIMENSIONS

19 W x 33 H x 19.5 D

SH 17.75

ORIGIN

Made in Pennsylvania

MATERIALS

American White Oak

In a nod to brutalism, the Highland Chair plays with slab-like, cantilevered forms and imperfect curves. These blunt shapes counterbalance the elegant and clear precision of machining. The thoughtful combination of scale and well-crafted detail showcase the natural grain variation of the material.

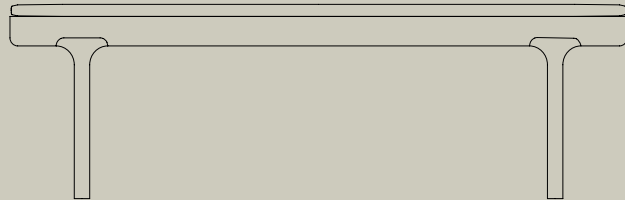
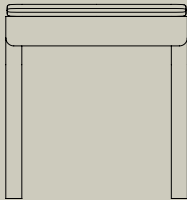

The Highland Bench \$3,200 - \$3,800

DIMENSIONS

60 L x 17 W x 18H

ORIGIN

Made in Pennsylvania

MATERIALS

American White Oak
Leather
Belgian Linen
Natural Latex Fill

UPHOLSTERY OPTIONS



Cognac
LEATHER



Sage
LINEN



Wheat
LINEN

Carefully detailed and designed to be as hardworking as it is elegant, the Highland Bench juxtaposes cantilevered forms against the clear precision of machining. Made from white oak and available with or without cushion. Bench cushion is upholstered in pure aniline leather or Belgian linens. The bench seats three.

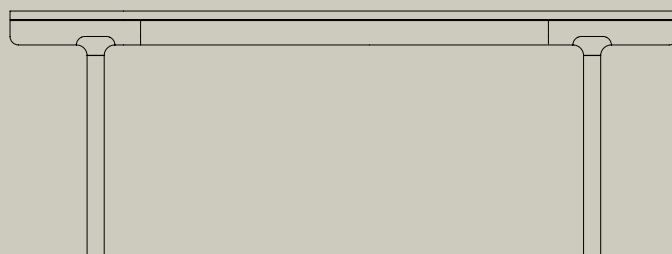
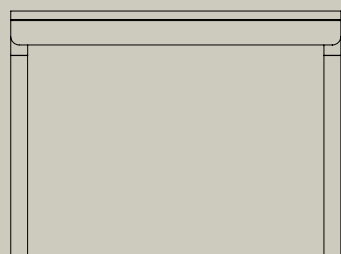

The Highland Desk \$6,000

DIMENSIONS

78 L x 39 W x 29.5 H

ORIGIN

Made in Pennsylvania

MATERIALS

American White Oak

Brass

FOOT OPTIONS



White Oak



Brass

Made from an expanse of solid white oak, and with legs punctuated by brass hardware, the Highland Desk can hold the center of a room. Well suited for architects or designers, the desk has a drawer sized for large format draft paper.

Standard species: White Oak
Finishes: Kalon Bare Finish
Standard Fabrics: Linen / Leather

Highland Collection

Custom dimensions, species and COM available upon request.
Estimated lead times and shipment: 8-10 weeks

The collection includes an extension table, a desk, chair and bench.

710



714



711



712



Beyond Beauty

Kalon (pronounced like ‘Talon’ but with a ‘K’) is an ancient, philosophical concept of ideal beauty that considers moral worth and usefulness as inextricable from aesthetics. When an object is kalon, it is beautiful because there is an inherent goodness that radiates from each detail. The truly beautiful is one and the same with the truly good.

Kalon Studios was founded not only to create products that stimulate and inspire, but to use design for positive change. It’s an inherently optimistic mission, and achieving it is no small feat. For us, it’s the seed of inspiration for every decision we make.



The ways we work

Producing with intention

We don't design to industry standards, we design and develop beyond them. Our pieces and materials meet some of the world's most stringent sustainability standards, but more importantly, they meet our high standards. Kalon views design as part of an ecosystem of impact: from those involved in creating work to the production choices we make, we consider the full picture. Each piece must give as much as it takes both to the environment and to the people involved in creating it.

Championing local craft

Kalon follows a philosophy of local manufacturing. Lumber is sustainably harvested from forests most local to where pieces are made. Similarly, all packing materials are sourced locally. Our intent is to sustain and revitalize the businesses, communities, and woodworking traditions in our communities.

Minding our impact

Our operations follow a small to Batch Size One production model. Within this approach, it is as efficient and cost effective to produce a single item as it is to produce a run of 1,000. In this way, we break from destructive cycles of mass production, overconsumption of resources, and wasteful overproduction. Additionally, every Kalon piece meets an extremely high standard of 90% material efficiency or more. Despite this already industry-leading example, we are continually redeveloping our manufacturing processes.