



Simple

kalon



Simple Collection - Ash



Simple Bed Detail - Ash



Simple Collection Detail – Ash



Kalon

Stemming from a belief in the beauty and emotive power of everyday objects, Kalon seeks to deepen our relationship and reverence for the things we live with. Kalon's work maintains a strong point of view informed by American furniture traditions and modernist design, with a focus on elemental forms, natural materials, and versatility. The studio prides itself on its intense attention to materiality, which is at the core of each design. With a commitment to ecologically-conscious, regional production, Kalon partners with small teams of highly skilled, fairly paid craftspeople and uses the highest quality, locally sourced natural materials and finishes. By balancing traditional craft modalities with high-tech precision manufacturing and modern forms, Kalon invites a new chapter of contemporary, sustainable design. Kalon was founded in 2007 by Michael Simmering and Johannes Pauwen and is based out of Los Angeles, California.

The Simple Collection

The Simple Collection explores living materials, purity of form and the quiet beauty of private spaces. Each piece is made from pure, honest materials including solid, oil-rubbed domestic hardwood and solid machined brass. The pared back design and beautiful detailing throughout the collection accentuates the beauty of natural materials. All Simple items are designed to work as stand alone pieces or to pair with other items in the collection. The unobtrusive beauty and relaxed elegance of the design lends itself to a variety of settings.

The collection is proudly built by some of the finest craftspeople in the country. All materials are chosen with a profound respect for the environment and with a respect for how the material ages.

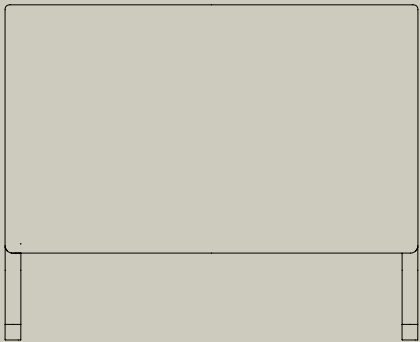

The Simple Bed \$ 2,850 - \$ 5,450

DIMENSIONS

Twin: 77 L x 41 W
 Full: 77 L x 56 W
 Queen: 81 L x 62 W
 King: 81 L x 78.25 W
 Cal King: 86 L x 74.25 W

ORIGIN

Made in Ohio

MATERIALS

Ash
 Black Walnut
 Brass

SPECIES OPTIONS



Walnut



Ash

FOOT OPTIONS

Brass
 Wood

FRAME OPTIONS

Platform (Height 12.25")
 Headboard (Height 12.25")

The Simple Bed is made from solid, oil-rubbed domestic Ash or Black Walnut. The bed is available in multiple configurations and sizes or built to custom spec upon request. Finished with a premium, organic plant-based oil/wax finish.

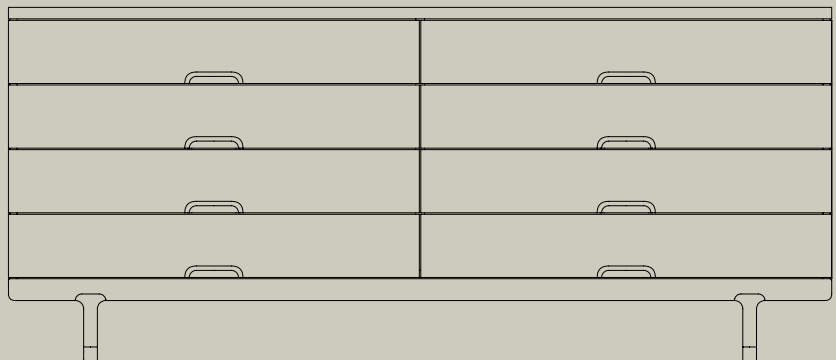
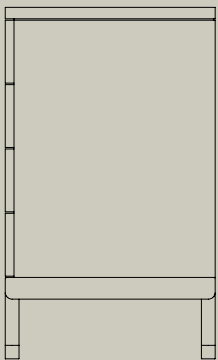

The Simple Dresser \$ 7,500 - \$ 7,750

DIMENSIONS

71 L x 18 W x 30.5 H

ORIGIN

Made in Ohio

MATERIALS

Ash
Black Walnut
Brass

SPECIES OPTIONS



Walnut



Ash

The Simple Dresser is an 8 drawer dresser made from pure, honest materials including solid, oil-rubbed domestic Ash or Black Walnut and solid machined brass. The unobtrusive beauty of the piece makes it ideal not only for the bedroom but for the living and dining rooms as well. Available with smooth soft-close drawer slides. Finished with a premium, organic plant-based oil/wax finish. Built to custom spec upon request.

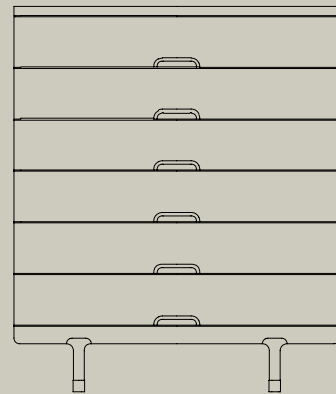
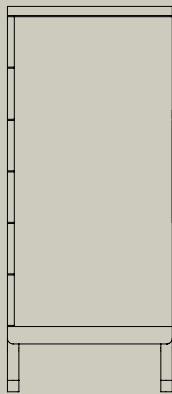

The Simple Tallboy \$ 6,250 - \$ 6,950

DIMENSIONS

71 L x 18 W x 30.5 H

ORIGIN

Made in Ohio

MATERIALS

Ash
Black Walnut
Brass

SPECIES OPTIONS



Walnut



Ash

The Simple Tallboy is an 6 drawer dresser made from pure, honest materials including solid, oil-rubbed domestic Ash or Black Walnut and solid machined brass. The unobtrusive beauty and relaxed elegance of the piece make it ideal not only for the bedroom but for the living and dining rooms as well. Available with smooth soft-close drawer slides. Finished with a premium, organic plant-based oil/wax finish. Built to custom spec upon request.

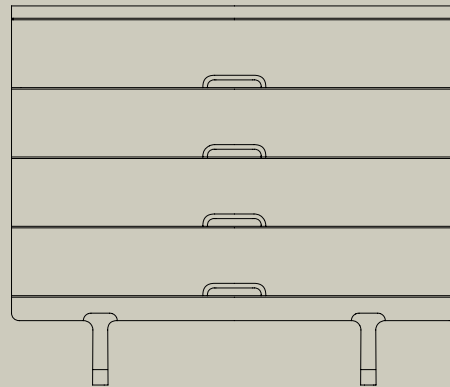
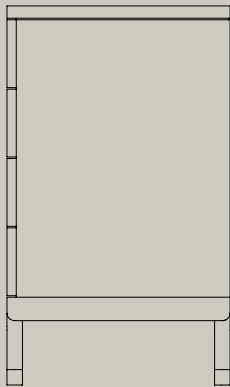

The Simple 4-Drawer \$ 5,250 - \$ 5,750

DIMENSIONS

71 L x 18 W x 30.5 H

ORIGIN

Made in Ohio

MATERIALS

Ash
Black Walnut
Brass

SPECIES OPTIONS

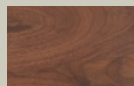

Walnut



Ash

The Simple 4-Drawer Dresser is made from pure, honest materials including solid, oil-rubbed Black Walnut or domestic Ash and solid machined brass. The unobtrusive beauty and relaxed elegance of the piece make it ideal not only for the bedroom but for the living and dining rooms as well. Available with smooth soft-close drawer slides. Finished with a premium, organic plant-based oil/wax finish. Built to custom spec upon request.

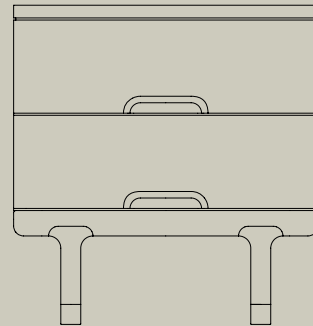
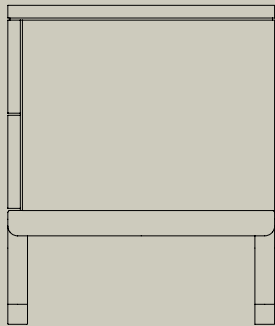

The Simple Side Table \$ 2,850 - \$ 3,250

DIMENSIONS

18 L x 16 W x 19 H

ORIGIN

Made in Ohio

MATERIALS

Ash
Black Walnut
Brass

SPECIES OPTIONS



Walnut



Ash

The Simple Side Table lends itself to a variety of settings and a number of uses. The low profile allows the piece to sit comfortably next to an armchair, sofa or bed. Made from pure, honest materials the 2-drawer piece features custom brass pulls and detailing including dovetail joinery. Available with smooth soft-close drawer slides. Finished with a premium, organic plant-based oil/wax finish. Built to custom spec upon request.

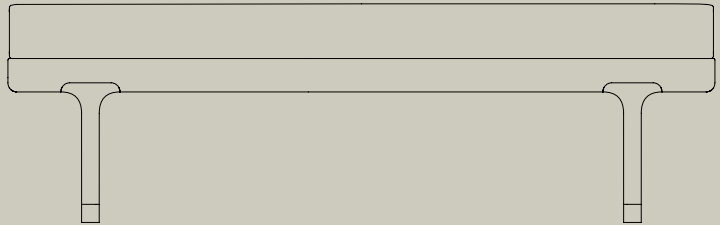
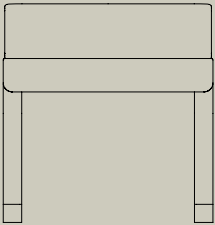

The Simple Bench \$ 5,250 - \$ 5,350

DIMENSIONS

60 W x 18 H x 17 D

ORIGIN

Made in Ohio

MATERIALS

Ash
Black Walnut
Leather
Brass

SPECIES OPTIONS

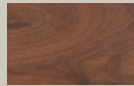

Walnut



Ash

The Simple Bench is made from pure, honest materials including solid, oil-rubbed domestic hardwoods, machined brass and pure aniline leather. The bench works as a stand alone piece or pairs exquisitely with other items in the collection. Built to custom spec upon request.

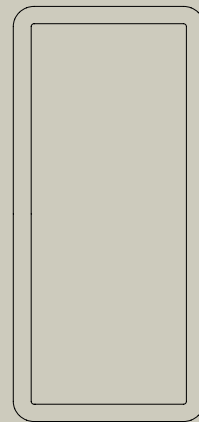
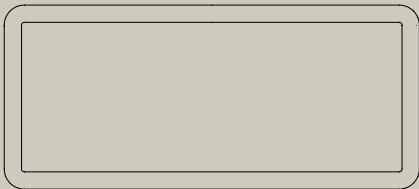

The Simple Mirror \$ 2,400 - \$2,700

DIMENSIONS

72 L x 3 W x 32 H

ORIGIN

Made in Ohio

MATERIALS

Ash
Black Walnut

SPECIES OPTIONS

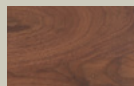

Walnut



Ash

The Simple Mirror is a large scale, 6-foot mirror with a solid, oil-rubbed, hardwood frame. The mirror can be hung in two orientations or casually lean against a wall. With its chamfered interior edges and soft, rounded corners, the piece highlights the beauty of natural grain structure. The unobtrusive beauty of the piece makes it ideal for any room in the house. Built to custom spec upon request.

Standard species: Ash / Black Walnut
Finishes: Kalon Bare Finish or Natural Oil/Wax
Standard Fabrics: Linen / Mohair / Leather
Hardware: Solid Brass (Unlacquered)

Custom dimensions, species and COM available upon request.
Estimated lead times and shipment: 8-10 weeks

Simple Collection

The collection includes a bed, 8-drawer dresser, 4-drawer dresser, tallboy, side table, upholstered bench and mirror.

801



801



802



803



804



805



806



807



Standard species: Ash / Black Walnut
Finishes: Kalon Bare Finish or Natural Oil/Wax
Standard Fabrics: Linen / Mohair / Leather
Hardware: Solid Brass (Unlacquered)

Custom dimensions, species and COM available upon request.
Estimated lead times and shipment: 8-10 weeks

Simple Collection

The collection includes a bed, 8-drawer dresser, 4-drawer dresser, tallboy, side table, upholstered bench and mirror.

801



801



802



803



804



805



806



807



Beyond Beauty

Kalon (pronounced like ‘Talon’ but with a ‘K’) is an ancient, philosophical concept of ideal beauty that considers moral worth and usefulness as inextricable from aesthetics. When an object is kalon, it is beautiful because there is an inherent goodness that radiates from each detail. The truly beautiful is one and the same with the truly good.

Kalon Studios was founded not only to create products that stimulate and inspire, but to use design for positive change. It’s an inherently optimistic mission, and achieving it is no small feat. For us, it’s the seed of inspiration for every decision we make.



The ways we work

Producing with intention

We don't design to industry standards, we design and develop beyond them. Our pieces and materials meet some of the world's most stringent sustainability standards, but more importantly, they meet our high standards. Kalon views design as part of an ecosystem of impact: from those involved in creating work to the production choices we make, we consider the full picture. Each piece must give as much as it takes both to the environment and to the people involved in creating it.

Championing local craft

Kalon follows a philosophy of local manufacturing. Lumber is sustainably harvested from forests most local to where pieces are made. Similarly, all packing materials are sourced locally. Our intent is to sustain and revitalize the businesses, communities, and woodworking traditions in our communities.

Minding our impact

Our operations follow a small to Batch Size One production model. Within this approach, it is as efficient and cost effective to produce a single item as it is to produce a run of 1,000. In this way, we break from destructive cycles of mass production, overconsumption of resources, and wasteful overproduction. Additionally, every Kalon piece meets an extremely high standard of 90% material efficiency or more. Despite this already industry-leading example, we are continually redeveloping our manufacturing processes.