



Highland

---

kalon





Highland Bench - White Oak



Highland Chair – White Oak



Highland Table and Chair





Highland Desk - White Oak





Highland Chair - White Oak



## Kalon

Stemming from a belief in the beauty and emotive power of everyday objects, Kalon seeks to deepen our relationship and reverence for the things we live with. Kalon's work maintains a strong point of view informed by American furniture traditions and modernist design, with a focus on elemental forms, natural materials, and versatility. The studio prides itself on its intense attention to materiality, which is at the core of each design. With a commitment to ecologically-conscious, regional production, Kalon partners with small teams of highly skilled, fairly paid craftspeople and uses the highest quality, locally sourced natural materials and finishes. By balancing traditional craft modalities with high-tech precision manufacturing and modern forms, Kalon invites a new chapter of contemporary, sustainable design. Kalon was founded in 2007 by Michaele Simmering and Johannes Pauwen and is based out of Los Angeles, California.

## The Highland Collection

Named for the California uplands, Highland calls upon the rugged expanse of California's oak-laden, golden-hued hillsides. Made in a generous scale and cut from solid oak, Highland's proportions seek a balance between substance and elegance. In a nod to brutalism, the collection plays with slab-like, cantilevered forms and imperfect curves. Knobby flourishes call to mind the irregular character of the coast's live oak trees endemic to California. These blunt shapes counterbalance the refined and clear precision of machining.

The collection, which includes a desk, extension dining table, chair and bench is built by a small team of master craftsmen in the North-Eastern United States using a mix of traditional and highly technological methods and a 360 degree approach to sustainability. Pieces are finished with Kalon's signature Bare Finish — a premium organic, natural oil-wax finish.

Highland was shot on location in Los Angeles at the Lovell Health House by Richard Neutra.



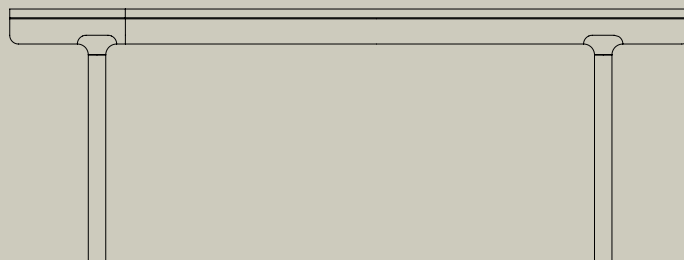
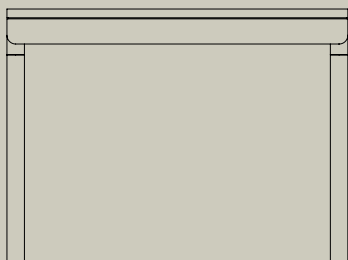

## The Highland Extension Dining Table

### DIMENSIONS

79"L x 39"W x 29.5"H

Full Extension 118"L

### ORIGIN

Made in Pennsylvania

### MATERIALS

White Oak

### STYLE OPTIONS



Extension



Fixed

Made in a generous scale and cut from solid white oak, the Highland Extension Dining Table utilizes a sophisticated butterfly system that nests leaves discretely below the piece. When collapsed, the table seats 6. Fully extended the table is 118" long, comfortably accommodating 4 additional place settings.



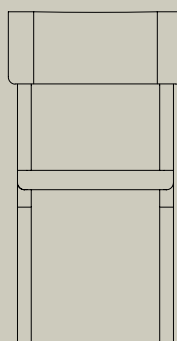
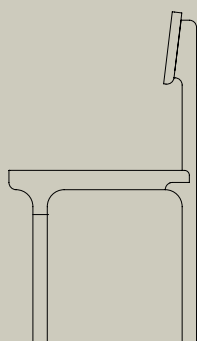

## The Highland Chair

### DIMENSIONS

19"W x 33"H x 19.5"D

SH 17.75"

### ORIGIN

Made in Pennsylvania

### MATERIALS

White Oak

In a nod to brutalism, the Highland Chair plays with slab-like, cantilevered forms and imperfect curves. These blunt shapes counterbalance the elegant and clear precision of machining. The thoughtful combination of scale and well-crafted detail showcase the natural grain variation of the material.

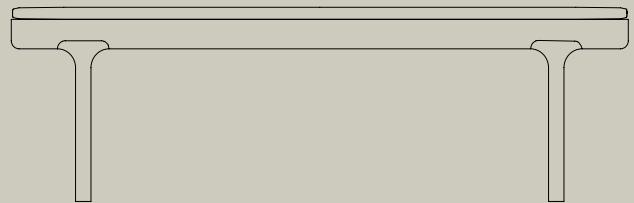
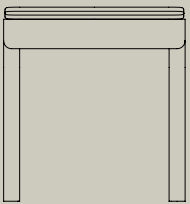

## The Highland Bench

### DIMENSIONS

60" L x 17" W x 18" H

### ORIGIN

Made in Pennsylvania

### MATERIALS

White Oak  
Leather  
Belgian Linen  
Natural Latex Fill

### UPHOLSTERY OPTIONS



Cognac  
LEATHER

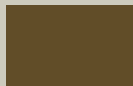

Sage  
LINEN



Wheat  
LINEN

Carefully detailed and designed to be as hardworking as it is elegant, the Highland Bench juxtaposes cantilevered forms against the clear precision of machining. Made from White Oak and available with or without cushion. Bench cushion is upholstered in pure aniline leather or Belgian linens. The bench seats three.





## The Highland Desk

### DIMENSIONS

78" L x 39" W x 29.5" H

### ORIGIN

Made in Pennsylvania

### MATERIALS

White Oak  
Brass

### FOOT OPTIONS



White Oak



Brass

Made from an expanse of solid White Oak, and with legs punctuated by brass hardware, the Highland Desk can hold the center of a room. Well suited for architects or designers, the desk has a drawer sized for large format draft paper.

Standard species: White Oak  
Finishes: Kalon Bare Finish  
Standard Fabrics: Linen / Leather

# Highland Collection

Custom dimensions, species and COM available upon request.  
Estimated lead times and shipment: 8-10 weeks

The collection includes an extension table, a desk, chair and bench.

710



714



711



712





## Beyond Beauty

---

Kalon (pronounced like ‘Talon’ but with a ‘K’) is an ancient, philosophical concept of ideal beauty that considers moral worth and usefulness as inextricable from aesthetics. When an object is kalon, it is beautiful because there is an inherent goodness that radiates from each detail. The truly beautiful is one and the same with the truly good.

Kalon Studios was founded not only to create products that stimulate and inspire, but to use design for positive change. It’s an inherently optimistic mission, and achieving it is no small feat. For us, it’s the seed of inspiration for every decision we make.



## The ways we work

---

### **Our Design Commitments — Beyond Human-Centered Design**

The decisions we make have an ecosystem of impact that reverberates far beyond the acts of ideation and creation, and every choice is a chance to support something — or not support something. By knowing this, we can design with intention, and activate the political, social, and cultural aspects of our respective practices. This means that from design to production, each piece must be functional, long-lasting, and of the highest quality. Along the way, it must support local communities, uphold craft traditions, and reimagine how we all engage with material goods.

### *Producing with intention*

We don't design to industry standards, we design and develop beyond them. Our pieces and materials meet some of the world's most stringent sustainability standards, but more importantly, they meet our standards. The materials we work with are carefully selected for their unique qualities as well as their ability to grow more beautiful with age and use. This is no accident — the longer we love a piece, the more sustainable that purchase becomes. To that end, pieces are designed with flexibility of use, durability, and timeless appeal in mind. Rather than planned obsolescence, we design with planned longevity in mind. Our hope is that our work will adapt to our customers' ever-changing needs and tastes over the course of a lifetime. We choose to work with natural materials to ensure end-of-life bioavailability of our designs. We use safe, non-toxic materials that don't emit harmful VOCs or odors.



*Championing local craft*

As we work to find sustainable solutions to manufacturing, we engage many of the newest — and sometimes, the oldest — methods and materials. Our intent is to sustain and revitalize the businesses, communities and craft traditions most local to us. By choosing to work with small-scale, often family-owned FSC-certified manufacturers and small teams of highly skilled craftspeople, we are keeping vital economic diversity, jobs, and skills in our communities. By bringing our approach to these manufacturers, we expand the industrial commons while amplifying our impact.

*Minding our impact*

We follow a philosophy of local manufacturing, harvesting lumber from the forests most local to where our pieces are made. Sustainable forestry practices, centering on domestic hardwoods, ensure that forests managed for the production of wood products contribute to healthy ecosystems. We use a Batch Size One production model, where it is as efficient and cost effective to produce a single item as it is to produce a run of 1,000. In this way, we break from the destructive cycles of mass production, overconsumption of resources, and wasteful overproduction. Additionally, every Kalon piece meets an extremely high standard of 90% material efficiency or more. Despite this already industry-leading example, we are continually redeveloping our manufacturing process to create less waste.