



Simple

---

kalon



Simple Collection - Ash





Simple Bed - Ash





Simple Collection Detail – Ash



## Kalon

Stemming from a belief in the beauty and emotive power of everyday objects, Kalon seeks to deepen our relationship and reverence for the things we live with. Kalon's work maintains a strong point of view informed by American furniture traditions and modernist design, with a focus on elemental forms, natural materials, and versatility. The studio prides itself on its intense attention to materiality, which is at the core of each design. With a commitment to ecologically-conscious, regional production, Kalon partners with small teams of highly skilled, fairly paid craftspeople and uses the highest quality, locally sourced natural materials and finishes. By balancing traditional craft modalities with high-tech precision manufacturing and modern forms, Kalon invites a new chapter of contemporary, sustainable design. Kalon was founded in 2007 by Michaele Simmering and Johannes Pauwen and is based out of Los Angeles, California.

## The Simple Collection

The Simple Collection explores living materials, purity of form and the quiet beauty of private spaces. Each piece is made from pure, honest materials including solid, oil-rubbed domestic hardwood and solid machined brass. The pared back design and beautiful detailing throughout the collection accentuates the beauty of natural materials. All Simple items are designed to work as stand alone pieces or to pair with other items in the collection. The unobtrusive beauty and relaxed elegance of the design lends itself to a variety of settings.



## The Simple Bed

### DIMENSIONS

Twin: 77 L x 41 W  
 Full: 77 L x 56 W  
 Queen: 81 L x 62 W  
 King: 81 L x 78.25 W  
 Cal King: 86 L x 74.25 W

### ORIGIN

Made in Ohio

### MATERIALS

Ash  
 Black Walnut  
 Brass

### SPECIES OPTIONS

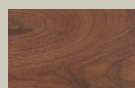

Walnut



Ash

### FOOT OPTIONS

Brass

Wood

### FRAME OPTIONS

Platform (Height 12.25")

Headboard (Height 12.25")

The Simple Bed is made from solid, oil-rubbed domestic Ash or Black Walnut. The bed is available in multiple configurations and sizes or built to custom spec upon request. Finished with a premium, organic plant-based oil/wax finish.



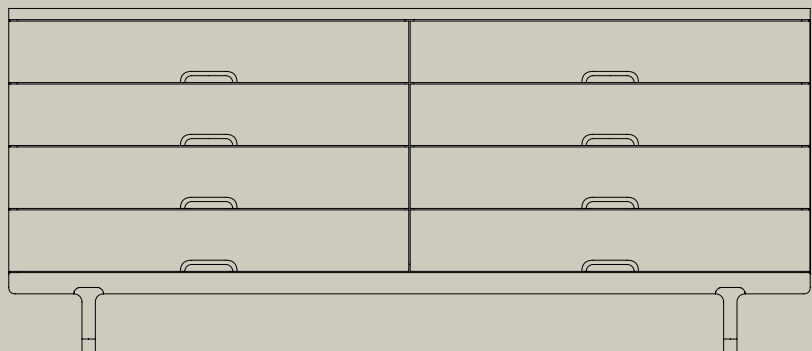
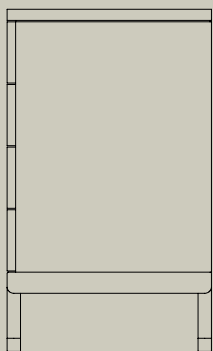

## The Simple Dresser

### DIMENSIONS

71" L x 18" W x 30.5" H

### ORIGIN

Made in Ohio

### MATERIALS

Ash  
Black Walnut  
Brass

### SPECIES OPTIONS

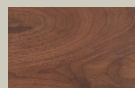

Walnut



Ash

The Simple Dresser is an 8 drawer dresser made from pure, honest materials including solid, oil-rubbed domestic Ash or Black Walnut and solid machined brass. The unobtrusive beauty of the piece makes it ideal not only for the bedroom but for the living and dining rooms as well. Available with smooth soft-close drawer slides. Finished with a premium, organic plant-based oil/wax finish. Built to custom spec upon request.

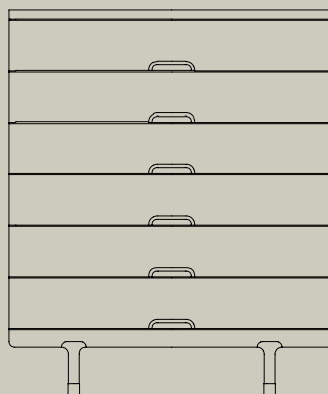
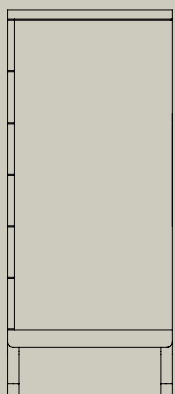

## The Simple Tallboy

### DIMENSIONS

71"L x 18"W x 30.5"H

### ORIGIN

Made in Ohio

### MATERIALS

Ash  
Black Walnut  
Brass

### SPECIES OPTIONS

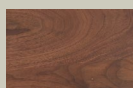

Walnut



Ash

The Simple Tallboy is a 6 drawer dresser made from pure, honest materials including solid, oil-rubbed domestic Ash or Black Walnut and solid machined brass. The unobtrusive beauty and relaxed elegance of the piece make it ideal not only for the bedroom but for the living and dining rooms as well. Available with smooth soft-close drawer slides. Finished with a premium, organic plant-based oil/wax finish. Built to custom spec upon request.



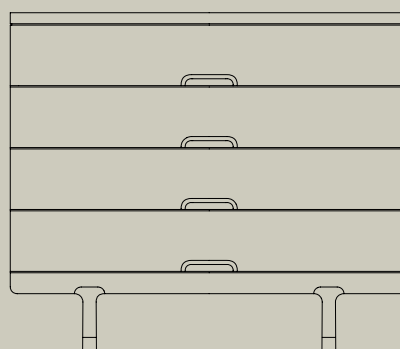
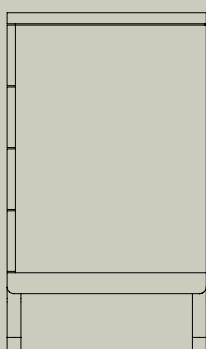

## The Simple 4-Drawer

### DIMENSIONS

35.5"L x 18"W x 30.75"H

### ORIGIN

Made in Ohio

### MATERIALS

Ash  
Black Walnut  
Brass

### SPECIES OPTIONS

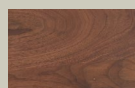

Walnut



Ash

The Simple 4-Drawer Dresser is made from pure, honest materials including solid, oil-rubbed Black Walnut or domestic Ash and solid machined brass. The unobtrusive beauty and relaxed elegance of the piece make it ideal not only for the bedroom but for the living and dining rooms as well. Available with smooth soft-close drawer slides. Finished with a premium, organic plant-based oil/wax finish. Built to custom spec upon request.

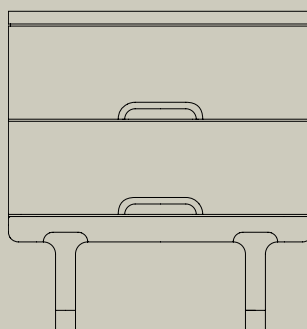
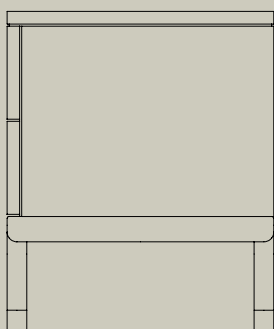

## The Simple Side Table

### DIMENSIONS

18" L x 16" W x 19" H

### ORIGIN

Made in Ohio

### MATERIALS

Ash  
Black Walnut  
Brass

### SPECIES OPTIONS

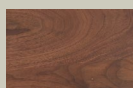

Walnut



Ash

The Simple Side Table lends itself to a variety of settings and a number of uses. The low profile allows the piece to sit comfortably next to an armchair, sofa or bed. Made from pure, honest materials the 2-drawer piece features custom brass pulls and detailing including dovetail joinery. Available with smooth soft-close drawer slides. Finished with a premium, organic plant-based oil/wax finish. Built to custom spec upon request.



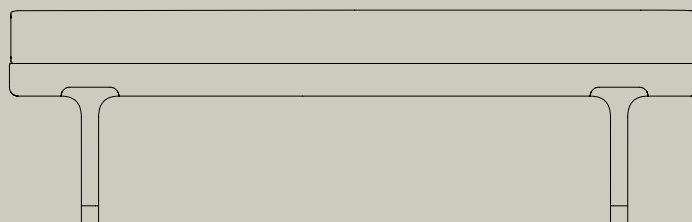
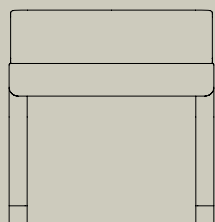

## The Simple Bench

### DIMENSIONS

60" W x 18" H x 17" D

### ORIGIN

Made in Ohio

### MATERIALS

Ash  
Black Walnut  
Leather  
Brass

### SPECIES OPTIONS

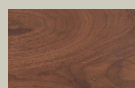

Walnut



Ash

The Simple Bench is made from pure, honest materials including solid, oil-rubbed domestic hardwoods, machined brass and pure aniline leather. The bench works as a stand alone piece or pairs exquisitely with other items in the collection. Built to custom spec upon request.

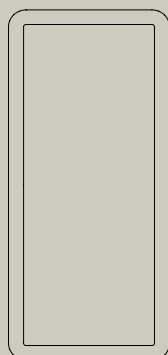
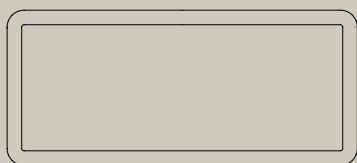

## The Simple Mirror

### DIMENSIONS

72"L x 3"W x 32"H

### ORIGIN

Made in Ohio

### MATERIALS

Ash  
Black Walnut

### SPECIES OPTIONS

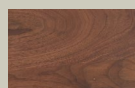

Walnut



Ash

The Simple Mirror is a large scale, 6-foot mirror with a solid, oil-rubbed, hardwood frame. The mirror can be hung in two orientations or casually lean against a wall. With its chamfered interior edges and soft, rounded corners, the piece highlights the beauty of the natural grain structure. The unobtrusive beauty of the piece makes it ideal for any room in the house. Built to custom spec upon request.



Standard species:	Ash / Black Walnut
Finishes:	Kalon Bare Finish or Natural Oil/Wax
Standard Fabrics:	Linen / Mohair / Leather
Hardware:	Solid Brass (Unlacquered)

# Simple Collection

Custom dimensions, species and COM available upon request.  
Estimated lead times and shipment: 8-10 weeks

The collection includes a bed, 8-drawer dresser, 4-drawer dresser, tallboy, side table, upholstered bench and mirror.

801



801



802



803



804



805



806



807



Standard species:	Ash / Black Walnut
Finishes:	Kalon Bare Finish or Natural Oil/Wax
Standard Fabrics:	Linen / Mohair / Leather
Hardware:	Solid Brass (Unlacquered)

# Simple Collection

Custom dimensions, species and COM available upon request.  
Estimated lead times and shipment: 8-10 weeks

The collection includes a bed, 8-drawer dresser, 4-drawer dresser, tallboy, side table, upholstered bench and mirror.

801



801



802



803



804



805



806



807





## Beyond Beauty

---

Kalon (pronounced like ‘Talon’ but with a ‘K’) is an ancient, philosophical concept of ideal beauty that considers moral worth and usefulness as inextricable from aesthetics. When an object is kalon, it is beautiful because there is an inherent goodness that radiates from each detail. The truly beautiful is one and the same with the truly good.

Kalon Studios was founded not only to create products that stimulate and inspire, but to use design for positive change. It’s an inherently optimistic mission, and achieving it is no small feat. For us, it’s the seed of inspiration for every decision we make.



## The ways we work

---

### **Our Design Commitments — Beyond Human-Centered Design**

The decisions we make have an ecosystem of impact that reverberates far beyond the acts of ideation and creation, and every choice is a chance to support something — or not support something. By knowing this, we can design with intention, and activate the political, social, and cultural aspects of our respective practices. This means that from design to production, each piece must be functional, long-lasting, and of the highest quality. Along the way, it must support local communities, uphold craft traditions, and reimagine how we all engage with material goods.

### *Producing with intention*

We don't design to industry standards, we design and develop beyond them. Our pieces and materials meet some of the world's most stringent sustainability standards, but more importantly, they meet our standards. The materials we work with are carefully selected for their unique qualities as well as their ability to grow more beautiful with age and use. This is no accident — the longer we love a piece, the more sustainable that purchase becomes. To that end, pieces are designed with flexibility of use, durability, and timeless appeal in mind. Rather than planned obsolescence, we design with planned longevity in mind. Our hope is that our work will adapt to our customers' ever-changing needs and tastes over the course of a lifetime. We choose to work with natural materials to ensure end-of-life bioavailability of our designs. We use safe, non-toxic materials that don't emit harmful VOCs or odors.

*Championing local craft*

As we work to find sustainable solutions to manufacturing, we engage many of the newest — and sometimes, the oldest — methods and materials. Our intent is to sustain and revitalize the businesses, communities and craft traditions most local to us. By choosing to work with small-scale, often family-owned FSC-certified manufacturers and small teams of highly skilled craftspeople, we are keeping vital economic diversity, jobs, and skills in our communities. By bringing our approach to these manufacturers, we expand the industrial commons while amplifying our impact.

*Minding our impact*

We follow a philosophy of local manufacturing, harvesting lumber from the forests most local to where our pieces are made. Sustainable forestry practices, centering on domestic hardwoods, ensure that forests managed for the production of wood products contribute to healthy ecosystems. We use a Batch Size One production model, where it is as efficient and cost effective to produce a single item as it is to produce a run of 1,000. In this way, we break from the destructive cycles of mass production, overconsumption of resources, and wasteful overproduction. Additionally, every Kalon piece meets an extremely high standard of 90% material efficiency or more. Despite this already industry-leading example, we are continually redeveloping our manufacturing process to create less waste.