



Element

---

kalon



Element Credenza - Douglas Fir, Aluminum





Element Bed and Side Table - Douglas Fir, Aluminum



Element Bed - Douglas Fir, Aluminum



Element Side Table - Douglas Fir, Aluminum







Element Bed - Douglas Fir, Aluminum



## Kalon

---

Stemming from a belief in the beauty and emotive power of everyday objects, Kalon seeks to deepen our relationship and reverence for the things we live with. Kalon's work maintains a strong point of view informed by American furniture traditions and modernist design, with a focus on elemental forms, natural materials, and versatility. The studio prides itself on its intense attention to materiality, which is at the core of each design. With a commitment to ecologically-conscious, regional production, Kalon partners with small teams of highly skilled, fairly paid craftspeople and uses the highest quality, locally sourced natural materials and finishes. By balancing traditional craft modalities with high-tech precision manufacturing and modern forms, Kalon invites a new chapter of contemporary, sustainable design. Kalon was founded in 2007 by Michael Simmering and Johannes Pauwen and is based out of Los Angeles, California.

## The Element Collection

---

With an emphasis on streamlined forms and honest materials, Element follows in the footsteps of over a century of Minimalism in design. Crafted with precision and restraint, the collection explores the architectural potential of contrast—pairing the cool precision of the brushed aluminum with the pared-down elegance of long-grained wood to express the practicality and poetry of clean lines and pure materials. The collection includes furniture and objects that utilize the practicality and poetry of aluminum.



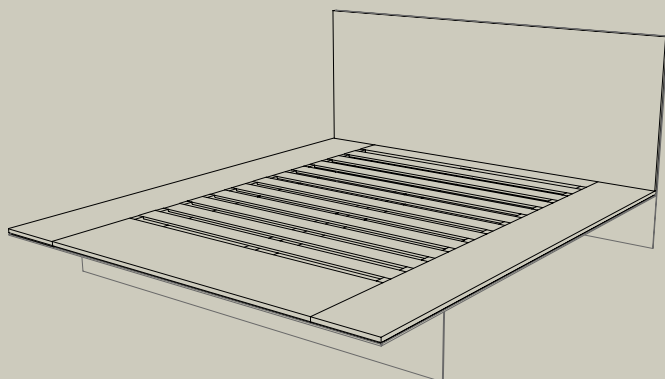

## The Element Bed

### DIMENSIONS

90" L x 80"W x 42" H

90" L x 96"W x 42" H

### ORIGIN

Made in Los Angeles

### MATERIALS

Douglas Fir, Aluminum

Pared down and exacting, the Element Bed is defined by large rectangular planes in wood and metal where features like a high back and generous platform present an elegant architectural form that unequivocally grounds. Made from solid, oil-rubbed Douglas Fir and brushed Aluminum. The bed is available in multiple sizes or built to custom spec upon request.



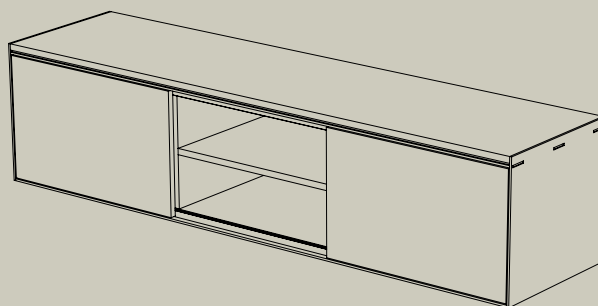
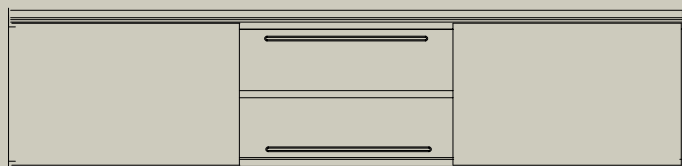

## The Element Credenza

### DIMENSIONS

18" L x 72" W x 16.75" H

### ORIGIN

Made in Los Angeles

### MATERIALS

Douglas Fir, Aluminum

The Element Credenza pairs long-grained Douglas Fir and brushed aluminum in an architectural form that balances clarity and function. Sliding Douglas Fir fronts reveal a composition of open and closed storage, designed to bring structure and refinement to any interior. Crafted with exacting precision, the credenza offers both visual presence and versatility—an elevated study in restraint and material integrity.

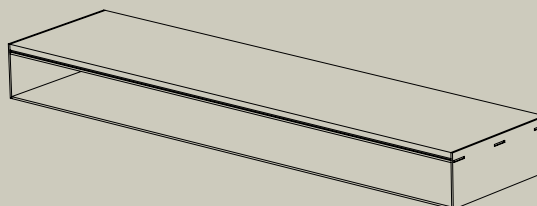

## The Element Console

### DIMENSIONS

18" L x 72" W x 7" H

### ORIGIN

Made in Los Angeles

### MATERIALS

Douglas Fir, Aluminum

A floating plane of brushed aluminum and Douglas Fir, the Element Console is designed to function as a console, shelf, or writing desk. Defined by clean lines and essential proportions, it creates a subtle architectural statement—shifting with light and shadow throughout the day. Crafted with seamless precision, the console reflects the collection's focus on balance, material honesty, and quiet presence.



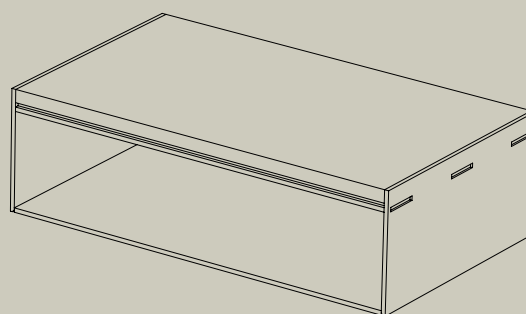
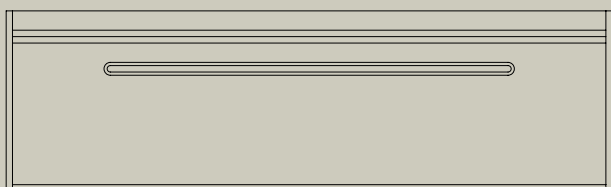

## The Element Side Table

### DIMENSIONS

14" L x 24" W x 7" H

### ORIGIN

Made in Los Angeles

### MATERIALS

Douglas Fir, Aluminum

The Element Side Table explores the balance of material, form, and proportion. Planes of brushed aluminum and long-grained Douglas Fir are paired with precision, creating an interplay of mass and lightness. Designed with visual restraint and built with seamless craftsmanship, the piece offers a quiet, sculptural presence—equally suited to the bedside or living space.

# Element Collection

Standard species: Douglas Fir  
Finishes: Kalon Bare Finish

Estimated lead times and shipment: 8-10 weeks

The collection includes a bed and case goods.

801-Q-F-A



813-CON



812-CR



811-S





## Beyond Beauty

---

Kalon (pronounced like ‘Talon’ but with a ‘K’) is an ancient, philosophical concept of ideal beauty that considers moral worth and usefulness as inextricable from aesthetics. When an object is kalon, it is beautiful because there is an inherent goodness that radiates from each detail. The truly beautiful is one and the same with the truly good.

Kalon Studios was founded not only to create products that stimulate and inspire, but to use design for positive change. It’s an inherently optimistic mission, and achieving it is no small feat. For us, it’s the seed of inspiration for every decision we make.



## The ways we work

---

### **Our Design Commitments — Beyond Human-Centered Design**

The decisions we make have an ecosystem of impact that reverberates far beyond the acts of ideation and creation, and every choice is a chance to support something — or not support something. By knowing this, we can design with intention, and activate the political, social, and cultural aspects of our respective practices. This means that from design to production, each piece must be functional, long-lasting, and of the highest quality. Along the way, it must support local communities, uphold craft traditions, and reimagine how we all engage with material goods.

### *Producing with intention*

We don't design to industry standards, we design and develop beyond them. Our pieces and materials meet some of the world's most stringent sustainability standards, but more importantly, they meet our standards. The materials we work with are carefully selected for their unique qualities as well as their ability to grow more beautiful with age and use. This is no accident — the longer we love a piece, the more sustainable that purchase becomes. To that end, pieces are designed with flexibility of use, durability, and timeless appeal in mind. Rather than planned obsolescence, we design with planned longevity in mind. Our hope is that our work will adapt to our customers' ever-changing needs and tastes over the course of a lifetime. We choose to work with natural materials to ensure end-of-life bioavailability of our designs. We use safe, non-toxic materials that don't emit harmful VOCs or odors.



*Championing local craft*

As we work to find sustainable solutions to manufacturing, we engage many of the newest — and sometimes, the oldest — methods and materials. Our intent is to sustain and revitalize the businesses, communities and craft traditions most local to us. By choosing to work with small-scale, often family-owned FSC-certified manufacturers and small teams of highly skilled craftspeople, we are keeping vital economic diversity, jobs, and skills in our communities. By bringing our approach to these manufacturers, we expand the industrial commons while amplifying our impact.

*Minding our impact*

We follow a philosophy of local manufacturing, harvesting lumber from the forests most local to where our pieces are made. Sustainable forestry practices, centering on domestic hardwoods, ensure that forests managed for the production of wood products contribute to healthy ecosystems. We use a Batch Size One production model, where it is as efficient and cost effective to produce a single item as it is to produce a run of 1,000. In this way, we break from the destructive cycles of mass production, overconsumption of resources, and wasteful overproduction. Additionally, every Kalon piece meets an extremely high standard of 90% material efficiency or more. Despite this already industry-leading example, we are continually redeveloping our manufacturing process to create less waste.